



2024 NC FFA State Convention Agricultural Career Show & Expo Information

Location:

Raleigh Convention Center
500 S. Salisbury Street
Raleigh, NC 27601

Hours:

Tuesday, June 25: 9:00 am-5:00 pm
Wednesday, June 26: 9:00 am-5:00 pm

The Agricultural Career Show & Expo will be held in **Exhibit Hall C** on the lower level of the Raleigh Convention Center. To access Exhibit Hall C from inside the Convention Center, enter from the mezzanine level and take the escalator down into the Exhibit Hall.

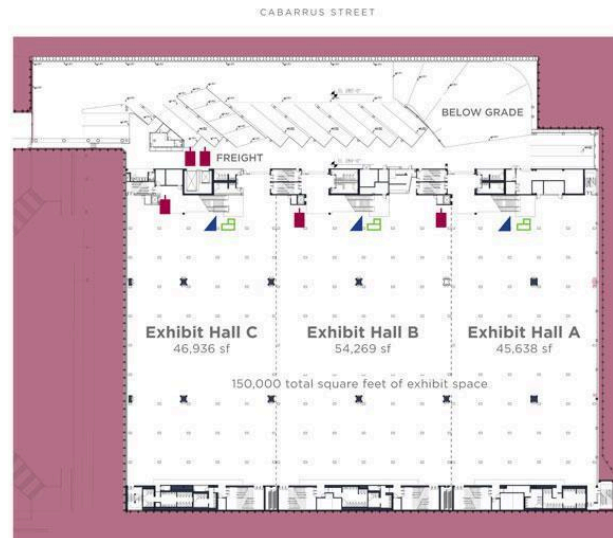
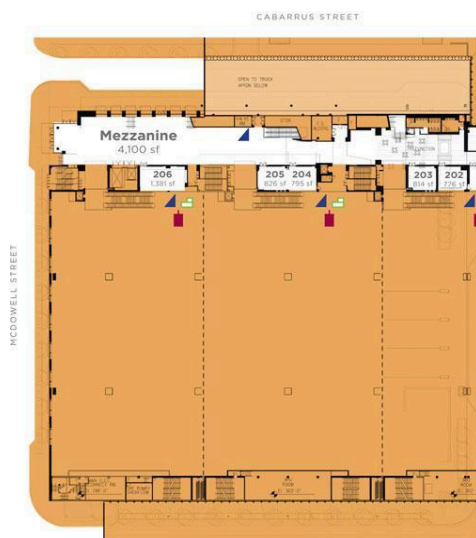

Registration:

[Registration](#) for the Career Show & Expo is due by May 17, 2024. Requests received after May 17, 2024 may not be considered.

Booths at the Career Show & Expo are free and include pipe and drape dividers and one table (no chairs are included). Booth sizes are 10' X 10' or 10' X 20'. WiFi is provided at no cost for light internet usage.

Optional items can be requested [on the form](#) for an additional charge:

- Chairs (+\$10 each)
- Additional tables (+\$20 each)
- Power (+\$100)
- Wired internet connection (+\$350)

Invoices for additional fees will be emailed following the event.

Set-Up:

All booths should be completely set up by 9:00 am on Tuesday, June 25 in preparation for the Grand Opening at 9:00 am. You may set up your booth on Monday, June 24 from 12:30 pm until 4:00 pm, or on Tuesday, June 25 from 8:00 am to 9:00 am. *Please do not arrive before 12:30 pm on Monday, June 24.*

If you need to unload equipment from your vehicle, you will use the loading dock to access the rear entrance of Exhibit Hall C. The entrance to the loading dock is behind the Red Hat Amphitheater on W. Lenoir Street.

A layout with booth assignments will be provided in advance so you will know where to set up when you arrive. Haley Hampton will be onsite to answer questions and assist.

LOADING DOCK ACCESS MAP

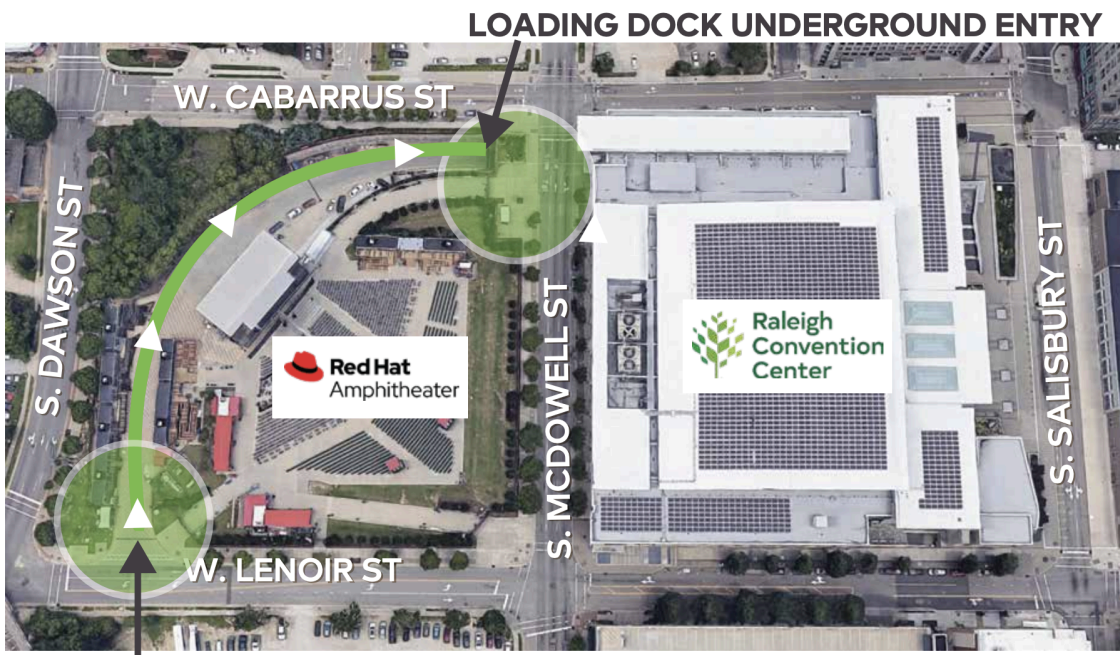

LOADING DOCK ACCESS

ENTER FROM W. LENOIR STREET AT REAR OF RED HAT AMPHITHEATER

Teardown:

Teardown for all booths may begin immediately after the Career Show & Expo closes at 4:00 pm on Wednesday, June 26. All equipment and belongings must be cleared by 11:00 am on Thursday, June 27.

Sales and Merchandise

Exhibitors that would like to sell merchandise at the 2024 Career Show and Expo will pay a \$300 booth fee. In addition, all merchandise being sold should be approved by Haley Hampton by June 1, 2024. Please submit lists and/or photos of all merchandise to haley@polishedmanuscripts.com by June 1, 2024. Any exhibitor may distribute free giveaways and promotional items.

General Information:

Parking is not included in Career Show & Expo registration. Paid parking is available at several nearby parking garages. Please familiarize yourself with the [Raleigh Convention Center parking options](#) and be prepared to pay to park.

If you are utilizing the loading dock, you must remove your vehicle as soon as you have unloaded. Vehicles may not be left in the loading dock area.

IMPORTANT: If you are bringing any equipment with a fuel tank inside the Exhibit Hall, fuel tanks shall have no more than 1/4 tank or five gallons of fuel, whichever is less. The City of Raleigh Fire Marshal will be inspecting all equipment, and you will be asked to remove the equipment/vehicle if your fuel levels are not in compliance.

No outside food is permitted inside the Raleigh Convention Center. There will be a concession stand located inside Exhibit Hall B with limited options available for lunch, or you may plan to eat at a nearby restaurant.

Hotel Information:**Marriott City Center**

This four-star Marriott Hotel provides accommodations as convenient as they are luxurious. After a full day of events at the Raleigh Convention Center, guests simply walk a few steps through a short corridor to the Marriott City Center.

500 Fayetteville Street
Raleigh, North Carolina 27601
Phone: 919-833-1120
Fax: 919-833-8912

www.MarriottRaleigh.com

Sheraton Raleigh Hotel

The Sheraton Raleigh is just a short walk away from the Raleigh Convention Center.

421 South Salisbury Street
Raleigh, North Carolina 27601
Phone 919-834-9900
Fax 919-833-1217

www.Sheraton.com

NC FFA Contact Information:

If you have any questions, please don't hesitate to contact Haley Hampton.

E-Mail: haley@polishedmanuscripts.com